

2023



CORMORANT II

GALAPAGOS CATAMARAN

CORMORANT II LUXURY GALAPAGOS ISLANDS CATAMARAN



The Cormorant II is our brand new luxury mega-catamaran equipped with ample cabins and the most sophisticated design to provide the smoothest of sailing throughout the Galapagos seas.

AN ECO-FRIENDLY LUXURIOUS WAY TO EXPLORE THE GALAPAGOS

- ✓ *Newest Catamaran in Galapagos*
- ✓ *All cabins with Private balconies*
- ✓ *Panoramic & spacious cabins*
- ✓ *Comfortable & modern design*





UPPER DECK PREMIUM SUITE (x2)

- Area 667 ft² / 62 m² (including balcony)
- 1 King Size bed
- TV and DVD in the room
- Panoramic windows
- Private balcony
- Private jacuzzi



UPPER DECK SUITE (x3)

- Area 371 ft² / 35 m² (including balcony)
- 2 Twin Beds (can be converted into California King Size)
- TV and DVD in the room
- Panoramic windows
- Private balcony





MAIN DECK SUITE (x4)

- Area 527ft² / 49m² (suites 1 & 2), 474ft² / 44m² (suites 3 & 4)
- 2 Twin Beds (can be converted into California King Size)
- Interconnected cabins
- TV and DVD in adjacent room
- Panoramic windows
- Private balcony



CORMORANT II CATAMARAN TECHNICAL SPECIFICATIONS

CONSTRUCTION	2023
LENGTH	148ft (45m)
BEAM	44ft (15m)
DRAFT	5ft (1,40 m)
SPEED	16 knots
CAPACITY	16 passengers
EXTERIOR	Naval Aluminium, GFRP
GENERATORS	3 generators of 100 KW each
CREW	12 members + 1 Cruise Director + 1 Guide

- ACCOMMODATION**
- **Main Deck:** 4 Interconnected Suites (two of 527ft²/ 49m² and two of 474ft²/ 44m²)
 - **Upper Deck:** 2 Premium Suites (667ft²/ 62m²), 3 Suites (371ft²/ 35m²) and Gym/Spa
 - **Sun Deck:** Jacuzzi (Please check with your Guide and Cruise Director for our Jacuzzi schedules.)

*All cabins with private balconies, private bathrooms, hot water and air-conditioning. Cabin size includes balcony.

SAFETY & NAVIGATION

- 2x 25-man life raft
- Navtex
- 2 GPS
- Depth Sounder
- 2 naval radars
- Fire detection and prevention systems, etc.



CORMORANT II GALAPAGOS ITINERARIES

8 DAY CRUISE (A)		5 DAY CRUISE
Sat	am pm	Arrival to Baltra Airport: Transfer to boat Santa Cruz: Bachas Beach
Sun	am pm	Genovesa: El Barranco Genovesa: Darwin Bay
Mon	am pm	South Plaza Island Santa Fe Island
Tue	am pm	San Cristobal: Pitt Point San Cristobal: Witch Hill
Wed	am pm	San Cristobal: Breeding Center San Cristobal: Lobos Island/Kicker Rock
Thu	am pm	Española: Suarez Point Española: Gardner Bay
Fri	am pm	Floreana: Post Office Bay/Baroness Viewing Point Floreana: Cormorant Point / Champion Islet
Sat	am pm	Santa Cruz: Twin Craters Santa Cruz: Highlands/Tortoise Breeding Center
8 DAY CRUISE (B)		8 DAY CRUISE (B)
Sun	am pm	Isabela: Tintoreras Islet/Sierra Negra Volcano Isabela: Wetlands/Tortoise Breeding Center
Mon	am pm	Isabela: Moreno Point Isabela: Elizabeth Bay
Tue	am pm	Fernandina: Espinosa Point Isabela: Vicente Roca Point
Wed	am pm	Santiago: Egas Port Santiago: Espumilla Beach/Buccaneer Cove
Thu	am pm	Bartholomew Island Santiago Island: Sullivan Bay
Fri	am pm	Santiago Island: Chinese Hat Santa Cruz: Dragon Hill
Sat	am pm	North Seymour Island Transfer to Baltra Airport

CORMORANT II DECKPLANS

MAIN
DECK

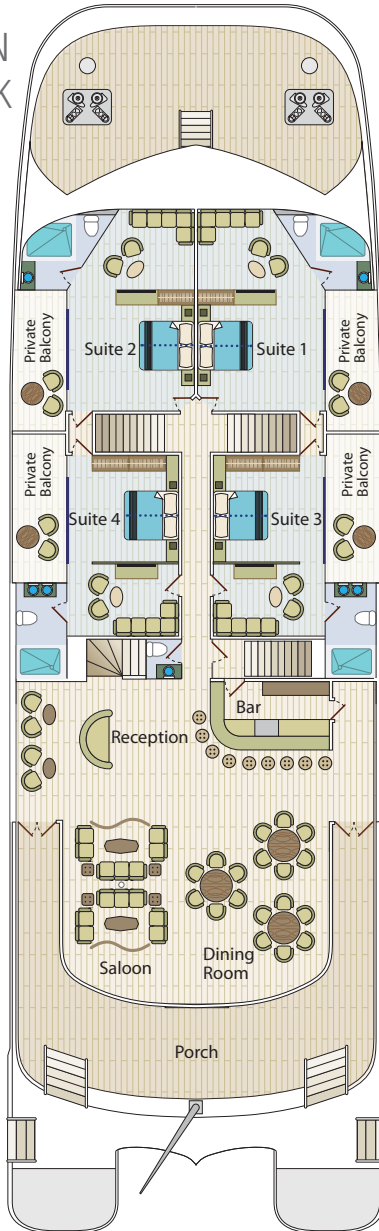

UPPER
DECK

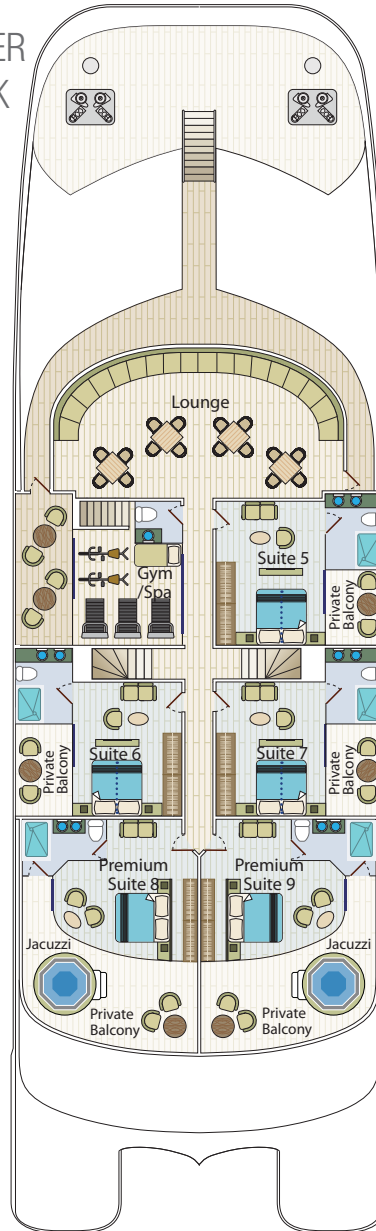

SUN
DECK

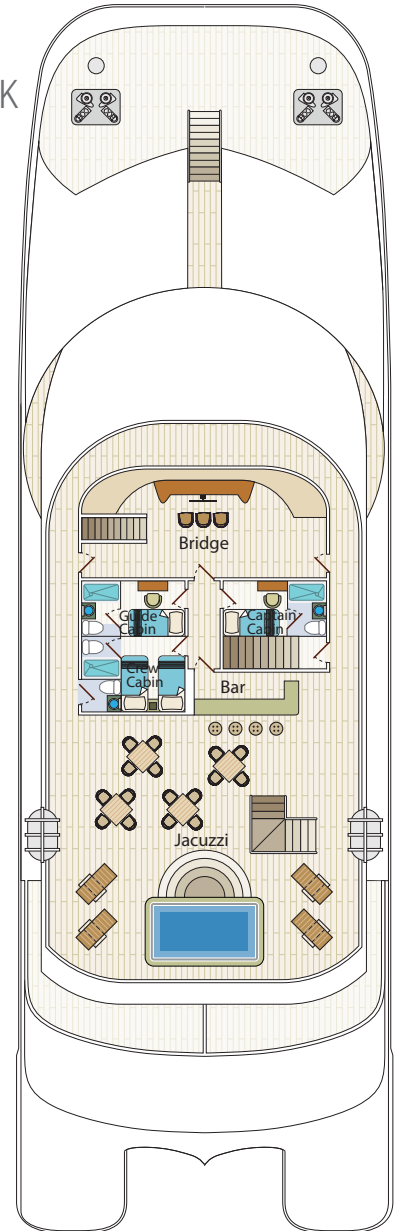

Escape routes are posted in each cabin. Please take the time to review these carefully.





VITA: 20-07-2022



CORMORANT II

GALAPAGOS CATAMARAN

www.cormorant-ii-cruise.com