



# CORMORANT I

GALAPAGOS CATAMARAN

# CORMORANT | LUXURY GALAPAGOS ISLANDS CATAMARAN



The recently renovated Cormorant incorporates the very best of Galapagos Catamaran design. The modern and ample accommodation includes panoramic windows, interconnected cabins, large suites, Jacuzzi, huge sun deck, al fresco dining area, and a private balcony for each of the spacious staterooms; providing the utmost comfort, privacy, and exclusivity while cruising the Galapagos Islands.

- ✓ *Recently refurbished*
- ✓ *Panoramic windows (floor to ceiling)*
- ✓ *Interconnected cabins*
- ✓ *Spacious and elegant social areas*

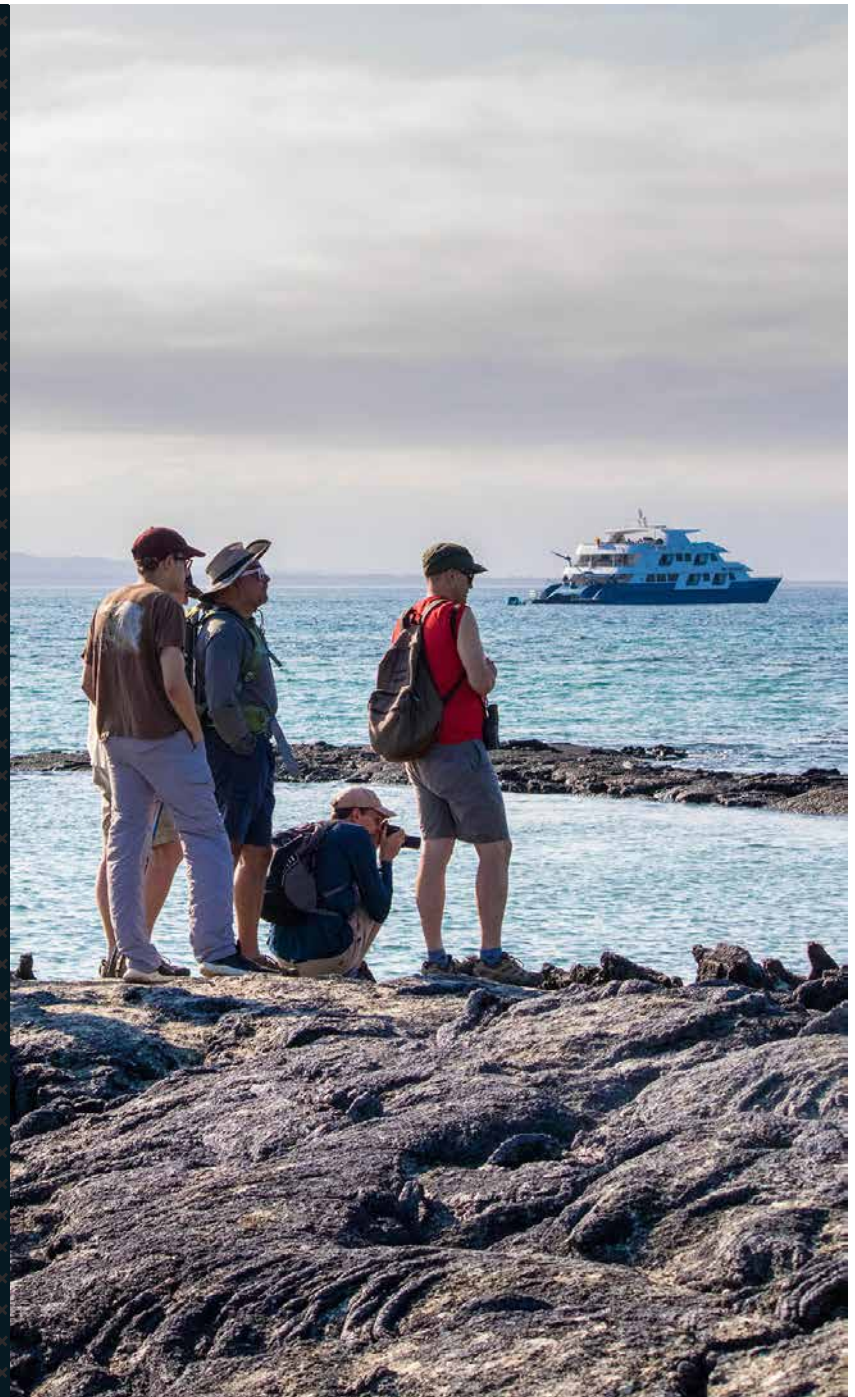



## MAIN DECK SUITE (x2)

- Area 409 ft<sup>2</sup> / 38 m<sup>2</sup> (including balcony)
- 1 King Size bed + sofa bed
- TV in adjacent room
- Panoramic windows
- Private balcony



## MAIN DECK STATEROOM (x2)

- Area 258 ft<sup>2</sup> / 24 m<sup>2</sup> (including balcony)
- 2 Twin Beds (can be converted into California King Size)
- Panoramic windows
- Private balcony

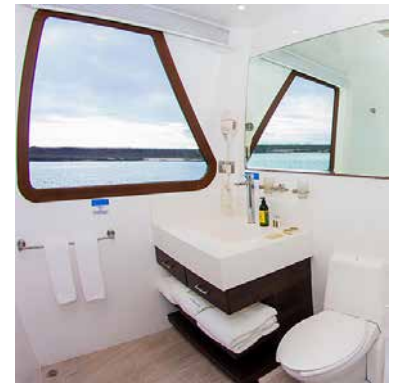



## UPPER DECK STATEROOM (x4)

- Area 258 ft<sup>2</sup> / 24 m<sup>2</sup> (including balcony)
- 2 Twin Beds (can be converted into California King Size)\*
- Panoramic windows
- Private balcony
- Interconnected cabins

\*Except for Cabin #5 which has a non-convertible King Size bed.



# CORMORANT I CATAMARAN TECHNICAL SPECIFICATIONS

<b>CONSTRUCTION</b>	2011
<b>LENGTH</b>	108 ft (33 m)
<b>BEAM</b>	39 ft (12 m)
<b>DRAFT</b>	5 ft (1,40 m)
<b>SPEED</b>	14 knots
<b>CAPACITY</b>	16 passengers
<b>MAIN ENGINES</b>	Cummins QSM 11 / 400 HP @ 2100 RPM
<b>WATER MAKER</b>	2000 Gallons / day
<b>EXTERIOR</b>	GFRP (fiber reinforced polymer)
<b>GENERATORS</b>	2 X 50 Kw
<b>CREW</b>	9 members + 1 Cruise Director + 1 Guide

- ACCOMMODATION**
- **Main Deck:** 2 Suites, 2 Double Staterooms
  - **Upper Deck:** 4 Connected Cabins
  - **Sun Deck:** Jacuzzi (Please check with your Guide and Cruise Director for our Jacuzzi schedules.)

\*All cabins with private balconies, private bathrooms, hot water and air-conditioning.

## SAFETY & NAVIGATION

- 2x 25-man life raft
- Navtex
- 2 GPS
- Depth Sounder
- 2 naval radars
- Fire detection and prevention systems, etc.

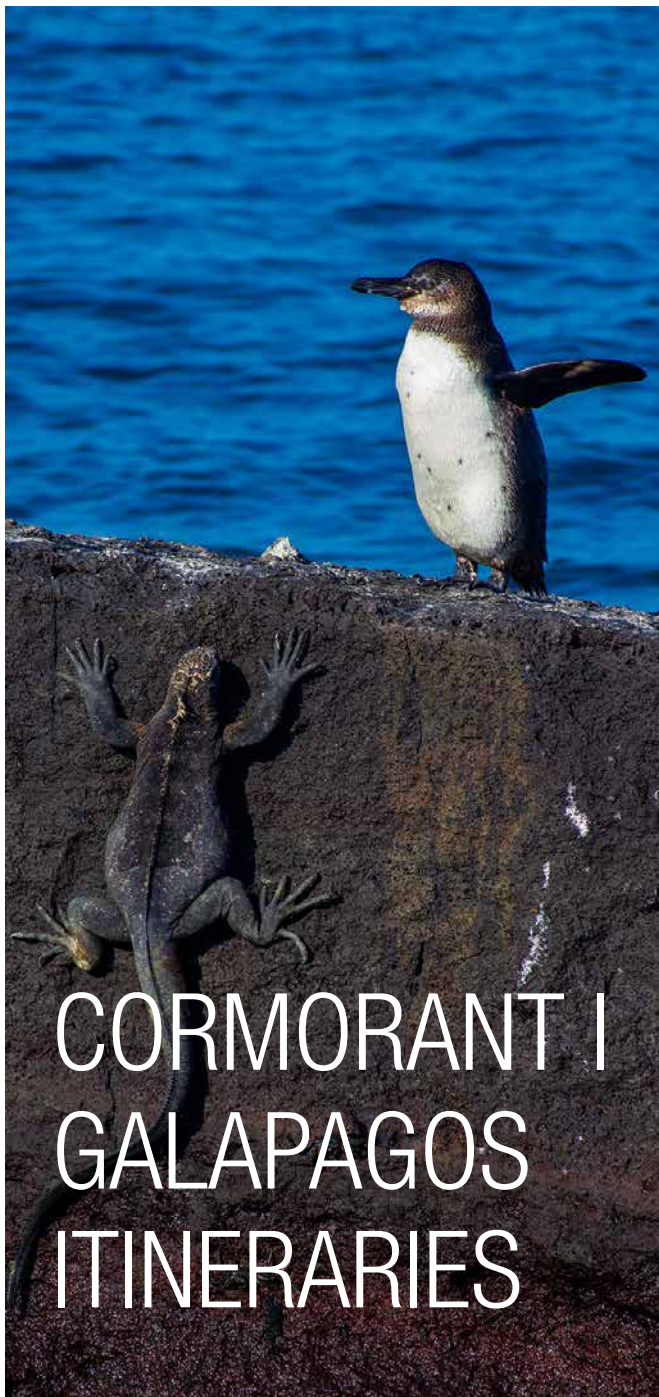

# CORMORANT I GALAPAGOS ITINERARIES

8 DAY CRUISE (A)		8 DAY CRUISE (B)		5 DAY CRUISE	4 DAY CRUISE	8 DAY CRUISE (B)
Sat	am pm	Arrival to Baltra Airport: Transfer to boat Santa Cruz: Bachas Beach				
Sun	am pm	Genovesa: El Barranco Genovesa: Darwin Bay				
Mon	am pm	South Plaza Island Santa Fe Island				
Tue	am pm	San Cristobal: Pitt Point San Cristobal: Witch Hill				
Wed	am pm	San Cristobal: Breeding Center San Cristobal: Lobos Island/Kicker Rock				
Thu	am pm	Española: Suarez Point Española: Gardner Bay				
Fri	am pm	Floreana: Post Office Bay/Baroness Viewing Point Floreana: Cormorant Point / Champion Islet				
Sat	am pm	Santa Cruz: Twin Craters Santa Cruz: Highlands/Tortoise Breeding Center				
Sun	am pm	Isabela: Tintoreras Islet/Sierra Negra Volcano Isabela: Wetlands/Tortoise Breeding Center				
Mon	am pm	Isabela: Moreno Point Isabela: Elizabeth Bay				
Tue	am pm	Fernandina: Espinosa Point Isabela: Vicente Roca Point				
Wed	am pm	Santiago: Egas Port Santiago: Espumilla Beach/Buccaneer Cove				
Thu	am pm	Bartholomew Island Santiago Island: Sullivan Bay				
Fri	am pm	Santiago Island: Chinese Hat Santa Cruz: Dragon Hill				
Sat	am pm	North Seymour Island Transfer to Baltra Airport				



● Arrival ● Visitor Site ● Departure ✈ Airport

\*Itineraries subject to change without previous notice.

# CORMORANT I DECKPLANS

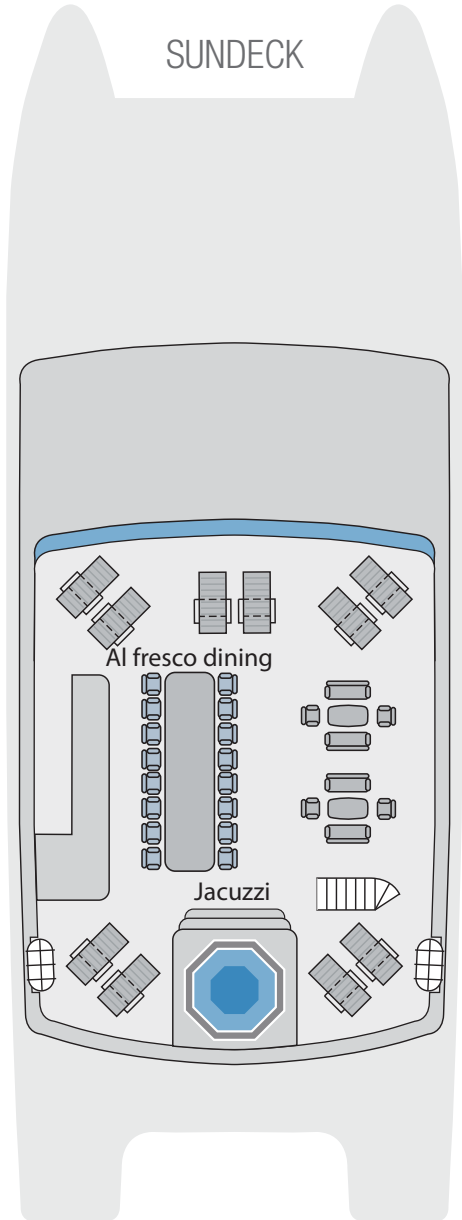
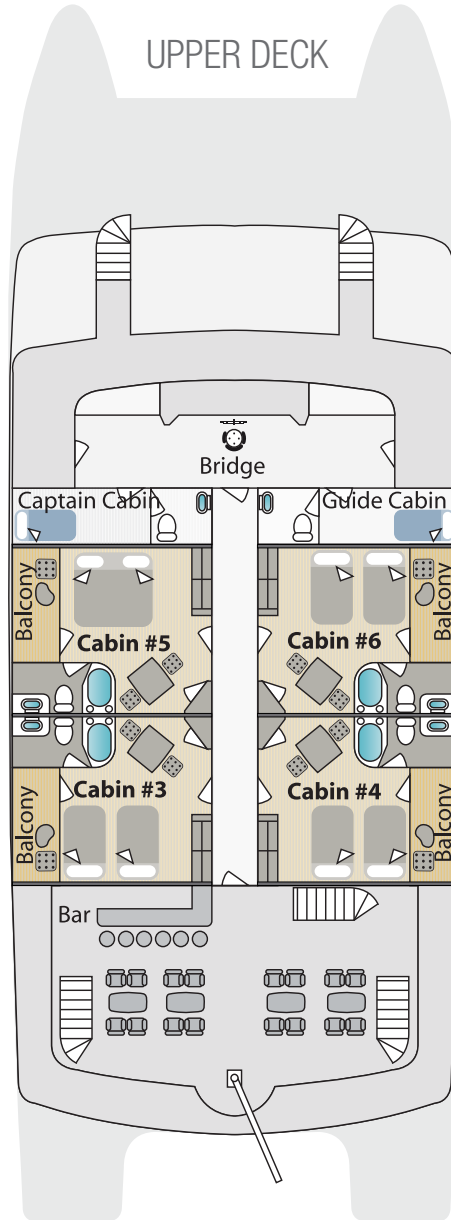
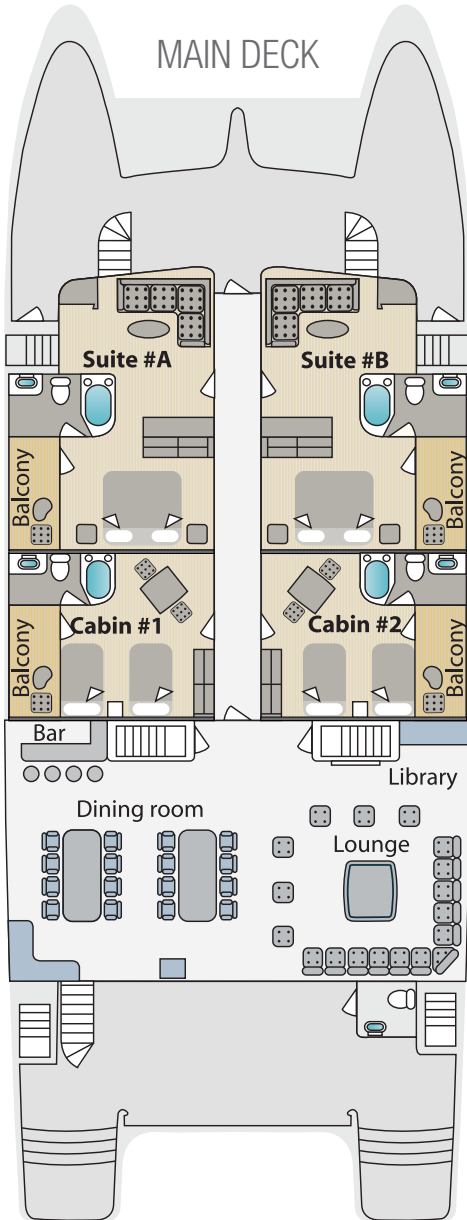

Escape routes are posted in each cabin. Please take the time to review these carefully.







# CORMORANT I

GALAPAGOS CATAMARAN

[www.cormorantgalapagos-cruise.com](http://www.cormorantgalapagos-cruise.com)